

SPECIFICATION 產品規格書

MODEL/型號: S10-07260S-31+R+K

LOT NO/工程號: 18073001

1. Standard Operating Conditions:

標準工作條件

1-1 Voltage operating range: 6.0~12.0 V DC.

工作電壓範圍: 6.0~12.0 V 直流.

1-2 Driving Voltage: 12.0V DC Constant between motor terminals.

轉動電壓: 馬達端子電壓 12.0V 直流恆壓.

1-3 Direction of Rotation: CW when viewed from output shaft side.

轉動方向: 面對馬達軸出方面, CW 轉向.

1-4 Position of Motor: To be placed horizontally when measuring.

馬達放置狀態: 測試時水平放置.

2. Environmental Conditions:

環境條件

2-1 Operation Temperature Range: -5°C~55°C

工作溫度範圍: -5°C~55°C

2-2 Operation Humidity Range: 30%~95%

工作濕度範圍: 30%~95%

3. Electrical Characteristics (at initial stage)

電氣特性 (於使用初期)

3-1 No Load Current: 0.10A max

空載電流: 0.10 安培 最大

3-2 No Load Speed: 24000rpm +/-12%

空載轉速: 每分鐘 24000轉 +/-12%

3-3 Rated Load Current: 0.21A max

負載電流: 0.21 安培 最大

3-4 Rated Load Speed: 19000rpm +/-15%

負載轉速: 每分鐘 19000轉 +/-15%

3-5 Rated Load: 22x12 mm fan.

負載: 22x12 mm 風葉.

3-6 Vibration Unit: No Load condition.

振動單位: 空載條件下

1.5 max 系數

3-7 Start Voltage: 2.4 V Max

起動電壓: 2.4 V 最大

DIRECTION OF ROTATION

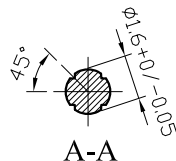
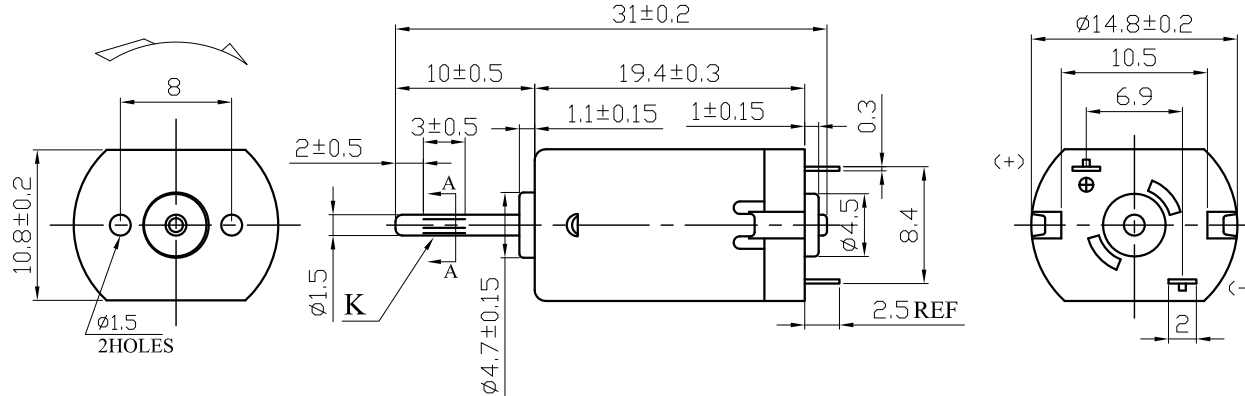

4. Noise Level:

噪音水平

4-1 Test Method: 100 mm Distance Test

檢測方法: 測試距離 100 mm

4-2 Noise Level: 65 dB(A) Max.

65 dB(A) 最大

NO LOAD		AT MAX. EFFICIENCY				STALL		
SPEED (r.p.m.)	CURRENT (A)	SPEED (r.p.m.)	CURRENT (A)	TORQUE (g.cm)	OUT PUT (W)	EFFICIENCY (%)	CURRENT (A)	TORQUE (g.cm)
24000	0.08	17480	0.21	7.1	1.27	50.5	0.56	26

Motor Performance Curve

馬達性能曲線

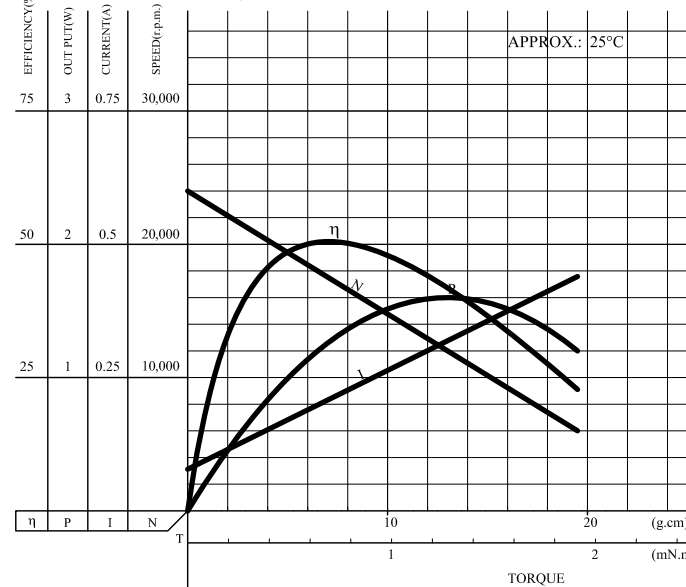

製錶:

陈顺焕

審核:

批准:

日期:

2008-09-05