

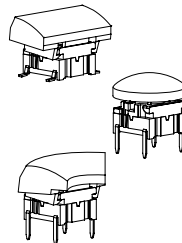

### Technical Data:

- through-hole or SMD
- 50mA/24VDC
- single pole/momentary
- 10.000.000 operations life time
- IP67 sealing
- temperature range:  
low temp: -40/+115°C  
high temp: -40/+160°C



### Dimensions 1ZB (through-hole)

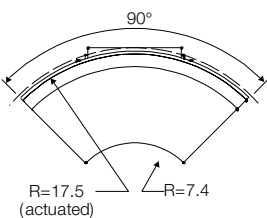
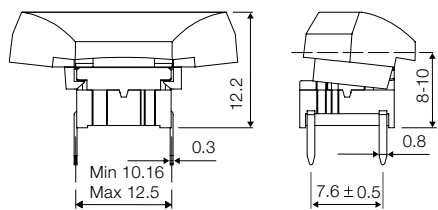

### PCB layout

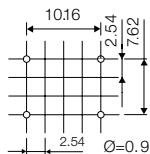

### Dimensions 1ZC (through-hole)

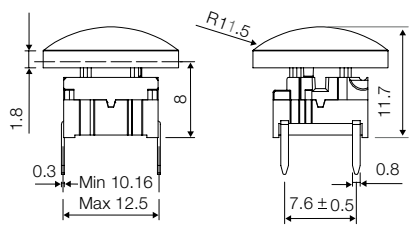

### PCB layout (top view)

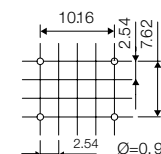
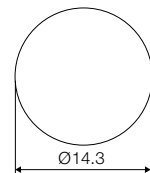

### Dimensions 1ZA (SMD)

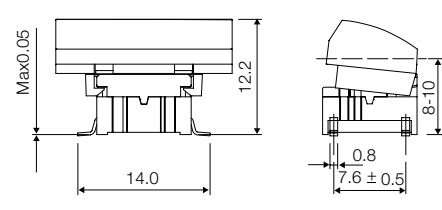

### PCB layout

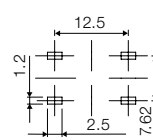
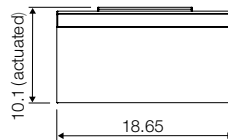

### HOW TO ORDER

**3 A** □ □ □ + □ □ □ □ □

**Switch** **Mounting**  
**T** through-hole  
**S** surface mount

**L 6** low temp.  
**H 9** high temp.

**Cap 1ZA**

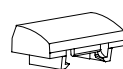

- 03** grey
- 06** white
- 09** black
- 30** ultra blue
- 40** dusty blue
- 50** metal dark blue
- 53** metal light grey
- 57** metal dark grey
- 58** metal bordeaux

**Cap 1ZB**

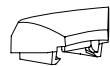

**3 F** □ □ □ + □ □ □ □ □

**Switch** **Mounting**  
**T** through-hole  
**S** surface mount

**L 6** low temp.  
**H 9** high temp.

**Cap 1ZC**



- 03** grey
- 06** white
- 09** black
- 30** ultra blue
- 40** dusty blue
- 50** metal dark blue
- 53** metal light grey
- 57** metal dark grey
- 58** metal bordeaux

### Standard versions:

3ATL6, 3ATH9, 3ASH9, 3ASH9R (tape/reel)  
 3FTL6, 3FTH9, 3FSH9, 3FSH9R (tape/reel)

Dimensions (mm): Unless otherwise specified, all tolerances ± 0.2

**Ordering example:** 3ATL6 + 1ZA58, 3FTL6 + 1ZC53

### Design example

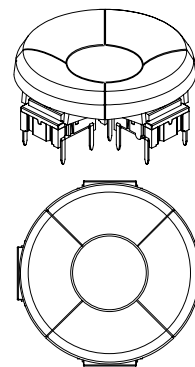

Consisting of: 4 x 3ATL6 + 4 x 1ZB + 1 x 3FTL6 + 1 x 1ZC  
 (3F in centre position)

**Recommended panel cut-out:**  
 ø = 35,0 - 35,5 Depending on application

### PCB layout

