



Thunder Tiger Raptor (TTR483x)

Distributed by Ace Hobby Distributors, Inc. • 116 W 19th St., Higginsville, MO 64037

Phone: 660-584-7121 • E-mail: acehobby@ctcis.net

CONFIGURING THE RAPTOR FOR 3D

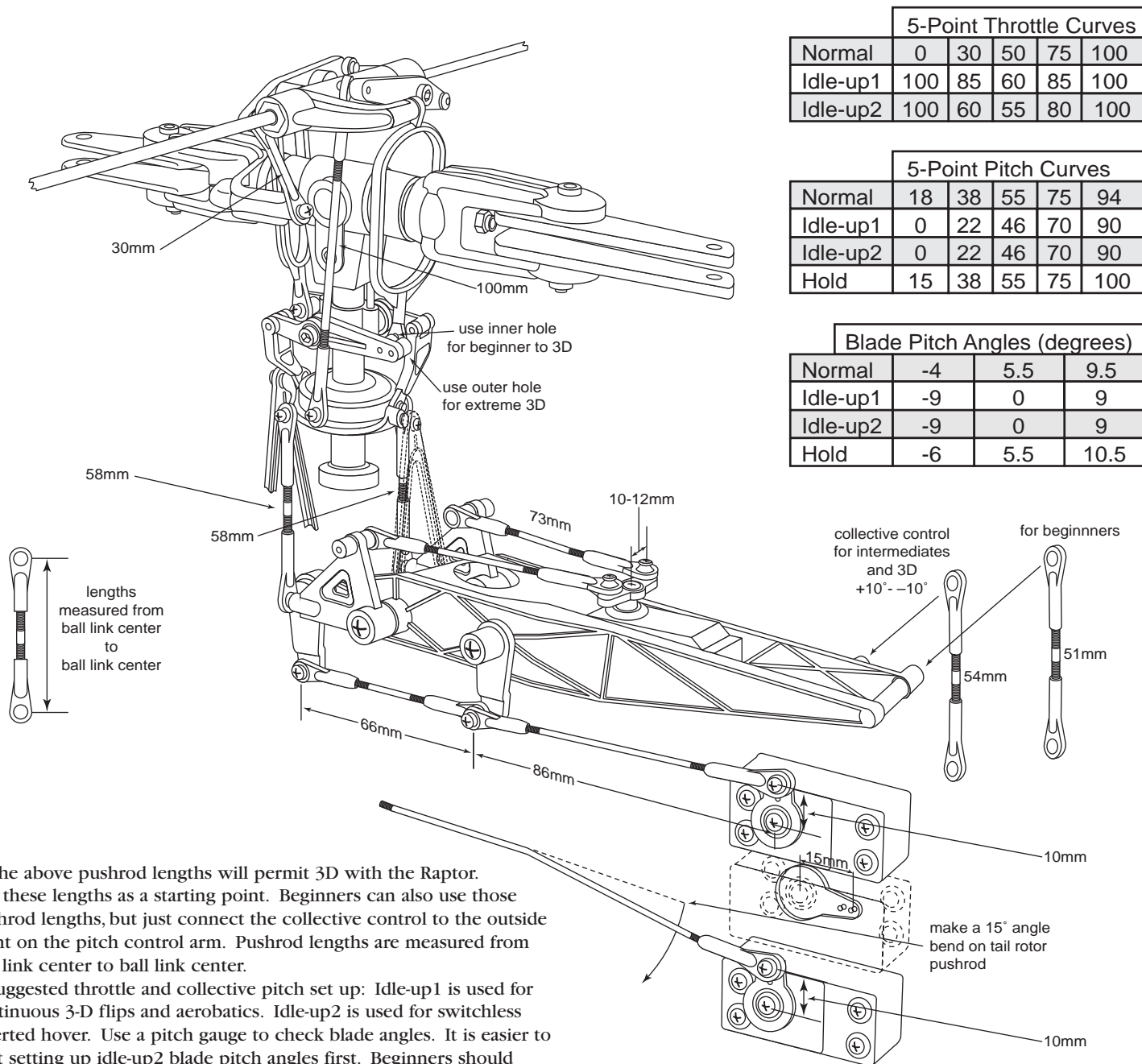

The above pushrod lengths will permit 3D with the Raptor. Use these lengths as a starting point. Beginners can also use those pushrod lengths, but just connect the collective control to the outside point on the pitch control arm. Pushrod lengths are measured from ball link center to ball link center.

Suggested throttle and collective pitch set up: Idle-up1 is used for continuous 3-D flips and aerobatics. Idle-up2 is used for switchless inverted hover. Use a pitch gauge to check blade angles. It is easier to start setting up idle-up2 blade pitch angles first. Beginners should inhibit idle-up1, idle-up2 and throttle hold. Beginners should only use the Normal mode values. The model should hover at around 1550 rpm in Normal mode, and flies at 1800 in idle-up1. Rotorspeed can be checked using TTR2000 MTF-301 helicopter tachometer.