

Steckerstifte

Fiches de goupille

Seamless pins

Werkstoff:
MS = Messing

Matière:
MS = laiton

Material:
MS = brass

Oberflächenbehandlung: Code
 bl = blank (0)
 ag = versilbert (1)
 au = vergoldet (2)
 ni = vernickelt (5)
 sn = verzinkt (8)

Traitements de surface: Code
 bl = brut (0)
 ag = argenté (1)
 au = doré (2)
 ni = nickelé (5)
 sn = étamé (8)

Surface-plating: Code
 bl = clean (0)
 ag = silver-plated (1)
 au = gold-plated (2)
 ni = nickel-plated (5)
 sn = tin-plated (8)

Bestellbeispiel:
 Exemple de commande: **1364A.68**
 Example of order: (1364 A MS sn)

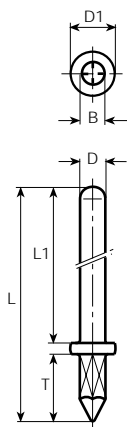

Print Trou Hole	D mm	L mm	T mm	L1 mm	D1 mm	B mm	Werkstoff Matière Material	Stand- Packg. 2'000	Artikel-Nr. Numéro d'article Part-No.	Werkzeug Outils Tools		
∅ 1	∅ 1	9.5	2.4	6.6	∅ 1.8	1.05	MS	•	1364A.6()	1035/85		
		10	3.5	6	∅ 1.8	1.05	MS	•	1364E.6()	1035/85		
		14.1	3	10.6	∅ 1.8	1.05	MS	•	1364S.6()	1035/86		
		10.8	4.5	5.8	∅ 1.8	1.05	MS	•	1364C.6()	1035/85		
		11	4.5	6	∅ 1.8	1.05	MS	•	1364G.6()	1035/85		
		11.5	3	8	∅ 1.8	1.05	MS	•	1364B.6()	1035/86		
		12.5	5	7	∅ 1.8	1.05	MS	•	1364F.6()	1035/85		
		15.5	3	12	∅ 1.8	1.05	MS	•	1364D.6()	1035/86		
		20	3.5	16	∅ 1.8	1.05	MS	•	1364T.6()	1035/86		
		18	6	11.5	∅ 1.8	1.05	MS	•	1364R.6()	1035/86		
		∅ 1.3	∅ 1.3	11	4.5	6	∅ 2.5	1.4	MS	•	1365A.6()	1035/84
				12.5	3.8	8.1	∅ 2.5	1.4	MS	•	1365F.6()	1035/83
13.5	5			8	∅ 2.5	1.4	MS	•	1365B.6()	1035/83		
13.5	5.5			7.5	∅ 2.5	1.4	MS	•	1365C.6()	1035/83		
14.7	2.5			11.7	∅ 2.5	1.4	MS	•	1365D.6()	1035/83		
15.9	5.7			9.7	∅ 2.5	1.4	MS	•	1365E.6()	1035/83		
16	3			12.5	∅ 2.5	1.4	MS	•	1365M.6()	1035/83		
∅ 1.33	9.5			3.5	5.5	∅ 2.5	1.43	MS	•	1365.6()	1035/84	

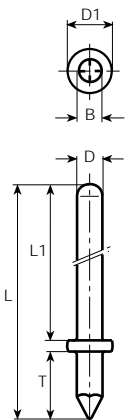

D mm	L mm	T mm	L1 mm	D1 mm	B mm	Werkstoff Matière Material	Stand- Packg. 2'000	Artikel-Nr. Numéro d'article Part-No.	Werkzeug Outils Tools
∅ 1	10	3.5	6	∅ 1.8	∅ 1	MS	•	1364P.6()	1035/85
	11	4.5	6	∅ 1.8	∅ 1	MS	•	1364K.6()	1035/85
	15	8.5	6	∅ 1.8	∅ 1	MS	•	1364M.6()	1035/85
	15.4	6	8.9	∅ 1.8	∅ 1	MS	•	1364H.6()	1035/86
	15.4	9	5.9	∅ 1.8	∅ 1	MS	•	1364L.6()	1035/85
∅ 1.3	16.2	5.9	9.8	∅ 2.5	∅ 1.3	MS	•	1365L.6()	1035/83

Andere Abmessungen auf Anfrage
 Autres dimensions sur demande
 Further dimensions on request