

VHF~UHF MIXER APPLICATION.

- Small Package.
- Small Delta Forward Voltage :  $\Delta V_F = 20\text{mV}$
- Small Delta Total Capacitance :  $\Delta C_T = 0.15\text{pF}$

MAXIMUM RATINGS (Ta = 25°C)

CHARACTERISTIC	SYMBOL	RATING	UNIT
Reverse Voltage	$V_R$	6	V
Forward Current	$I_F$	15	mA
Junction Temperature	$T_j$	125	°C
Storage Temperature Range	$T_{slg}$	-55~125	°C

Pin Assignment

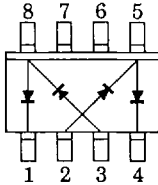

Marking

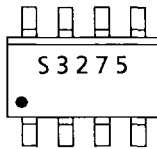

Unit in mm

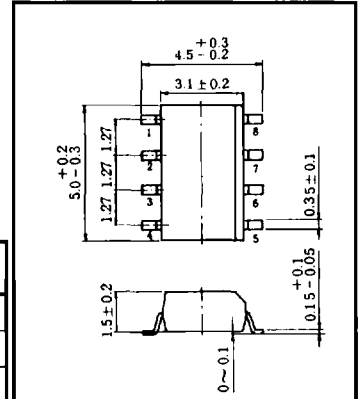

1. CATHODE 1
2. ANODE 3
3. ANODE 2
4. CATHODE 4
5. CATHODE 3, ANODE 4
6. N.C.
7. N.C.
8. ANODE 1, CATHODE 2

JEDEC	—
EIAJ	—
TOSHIBA	1-5J1A

Weight : 0.05g

ELECTRICAL CHARACTERISTICS (Ta = 25°C)

CHARACTERISTIC	SYMBOL	TEST CONDITION	MIN.	TYP.	MAX.	UNIT
Reverse Voltage	$V_R$	$I_R = 10\mu\text{A}$	6	—	—	V
Reverse Current	$I_R$	$V_R = 5\text{V}$	—	—	0.5	$\mu\text{A}$
Forward Voltage	$V_{F(1)}$	$I_F = 0.1\text{mA}$	—	0.32	—	V
Forward Voltage	$V_{F(2)}$	$I_F = 10\text{mA}$	0.45	0.53	0.60	V
Total Capacitance	$C_T$	$V_R = 0\text{V}, f = 1\text{MHz}$	—	0.65	0.9	pF
Delta Forward Voltage	$\Delta V_F$	$I_F = 10\text{mA}$ (Note)	—	—	20	mV
Delta Total Capacitance	$\Delta C_T$	$V_R = 0\text{V}, f = 1\text{MHz}$ (Note)	—	—	0.15	pF

(Note) : Difference between 4 Device in 1 package.

