

P/N AM1090B472

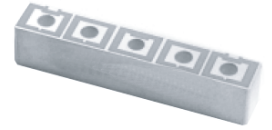

Meets RoHS requirements

### Electrical Specifications

Parameter	Frequency (MHz)	Typical @ 25°C	Spec. @ 25°C
Passband Insertion Loss	1085-1095	4.2 dB	4.5 dB max
Passband Return Loss	1085-1095	10.5 dB	10.0 dB min
Attenuation	1065	57.2 dB	55.0 dB min
Attenuation	1113	67.3 dB	55.0 dB min
Power Rating			5W
Impedance			50

### Electrical response

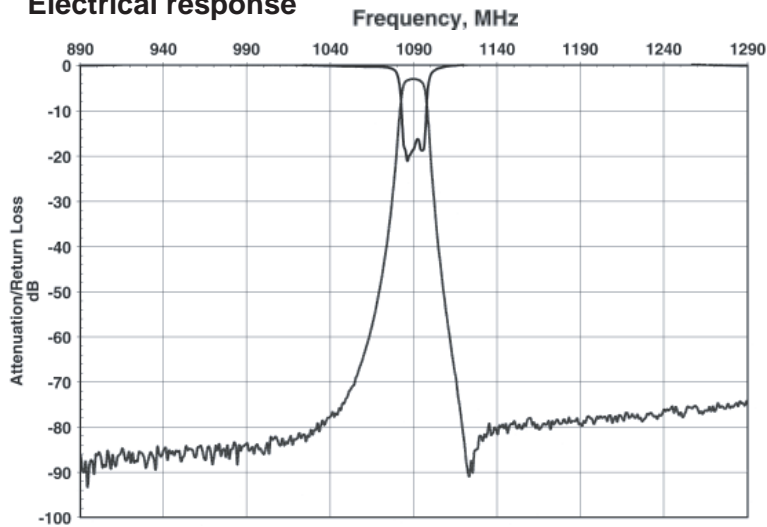

### PCB Layout

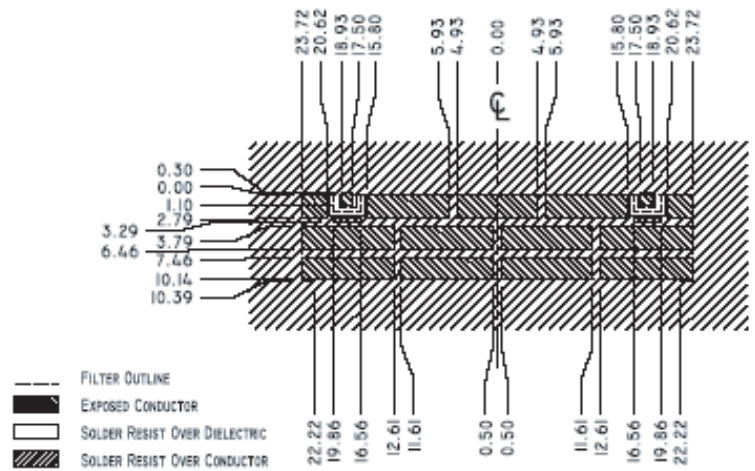

### Mechanical Drawing

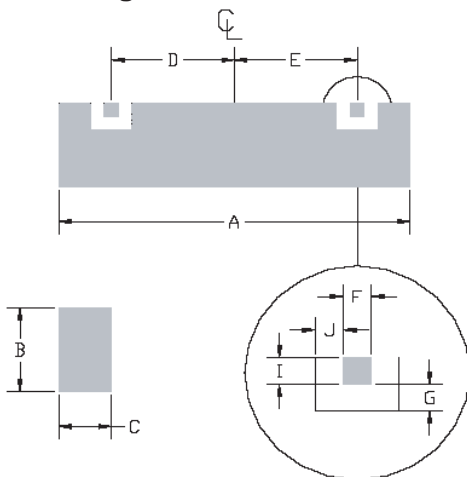

Dim	Nominal (mm)	Tolerance (mm) +/- or max
A	47.921	max
B	10.287	max
C	7.850	max
D	18.212	0.127
E	18.212	0.127
F	2.032	0.127
G	0.635	0.127
I	1.397	0.127
J	0.635	0.127